

KURT'S MIND TRICK

[HTTP://PADAWAN.SURFHIERE.NET](http://PADAWAN.SURFHIERE.NET)

This file was downloaded from Kurt's Mind Trick website and was created by Kurt Kitchen for use with the Star Wars Roleplaying Game by Wizards of the Coast. Please don't release this document in any other form, charge any type of fee for it, or presume to take credit for it's creation in any way. Please give credit where credit is due! You are free to share this file so long as those guidelines are met. Be sure to come back for my updates and new material. Thanks for visiting and happy gaming!

DECK 1 TOPSIDE HOLD (AT 85%)

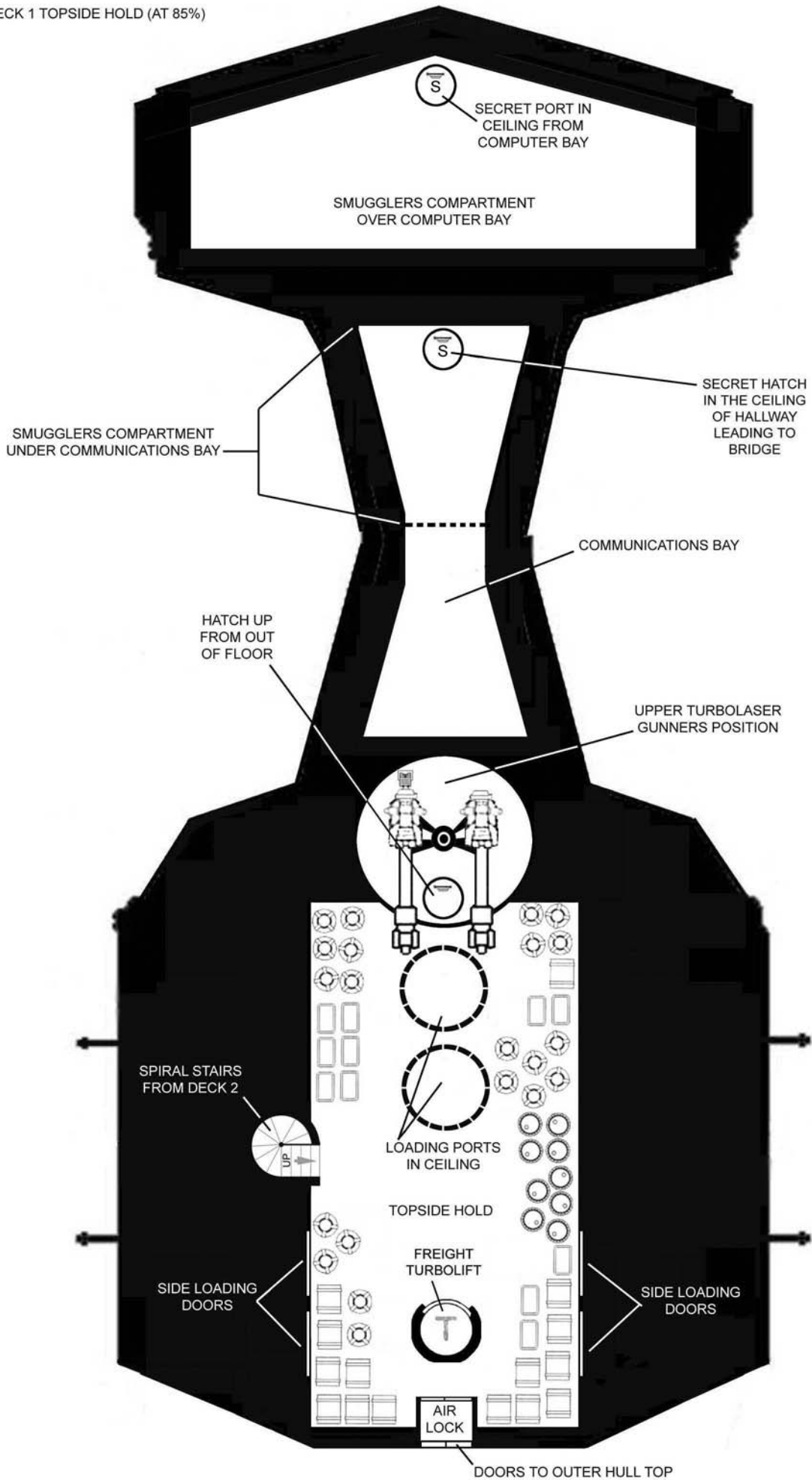

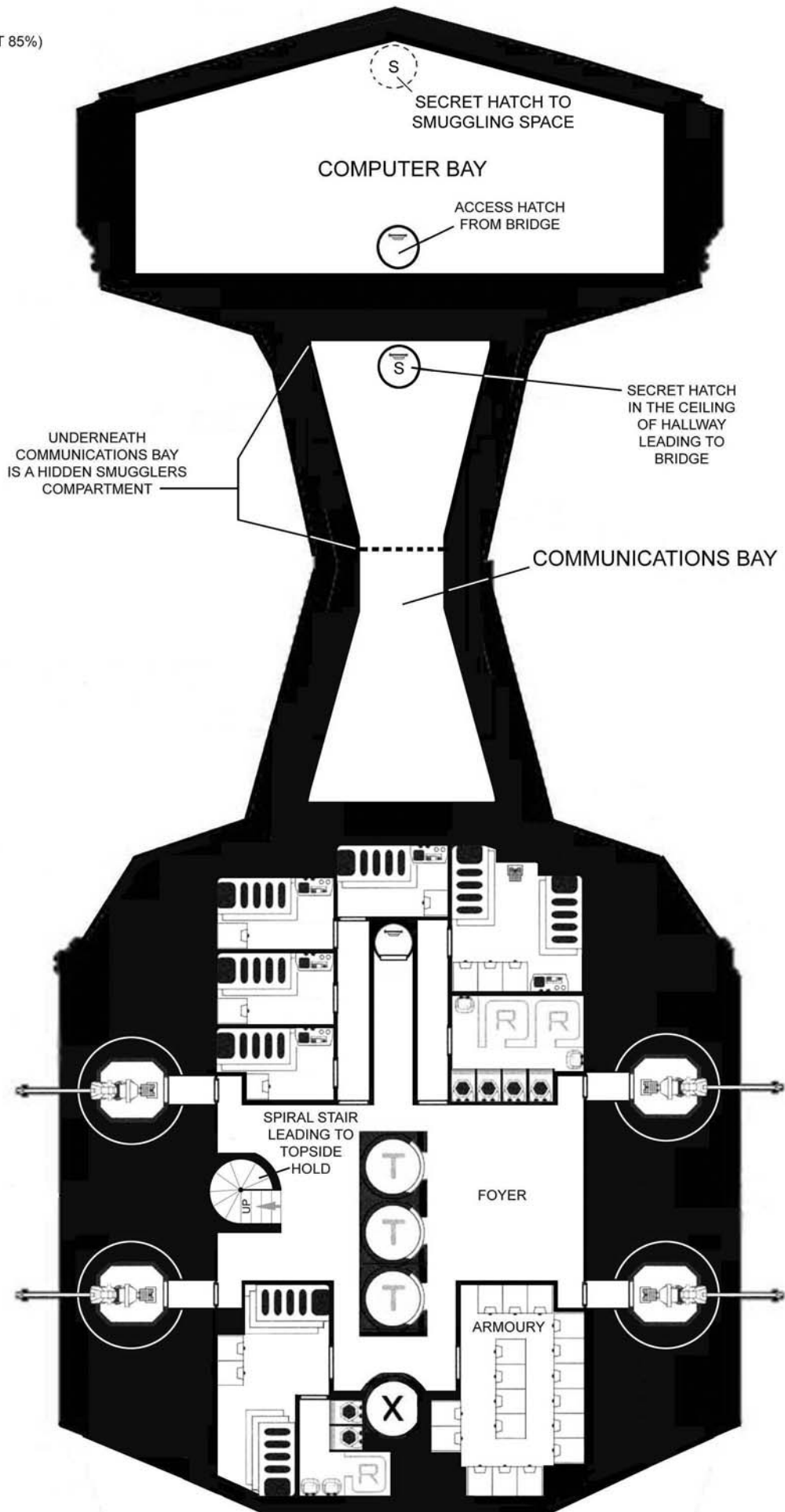

DECK 3 COMMAND DECK

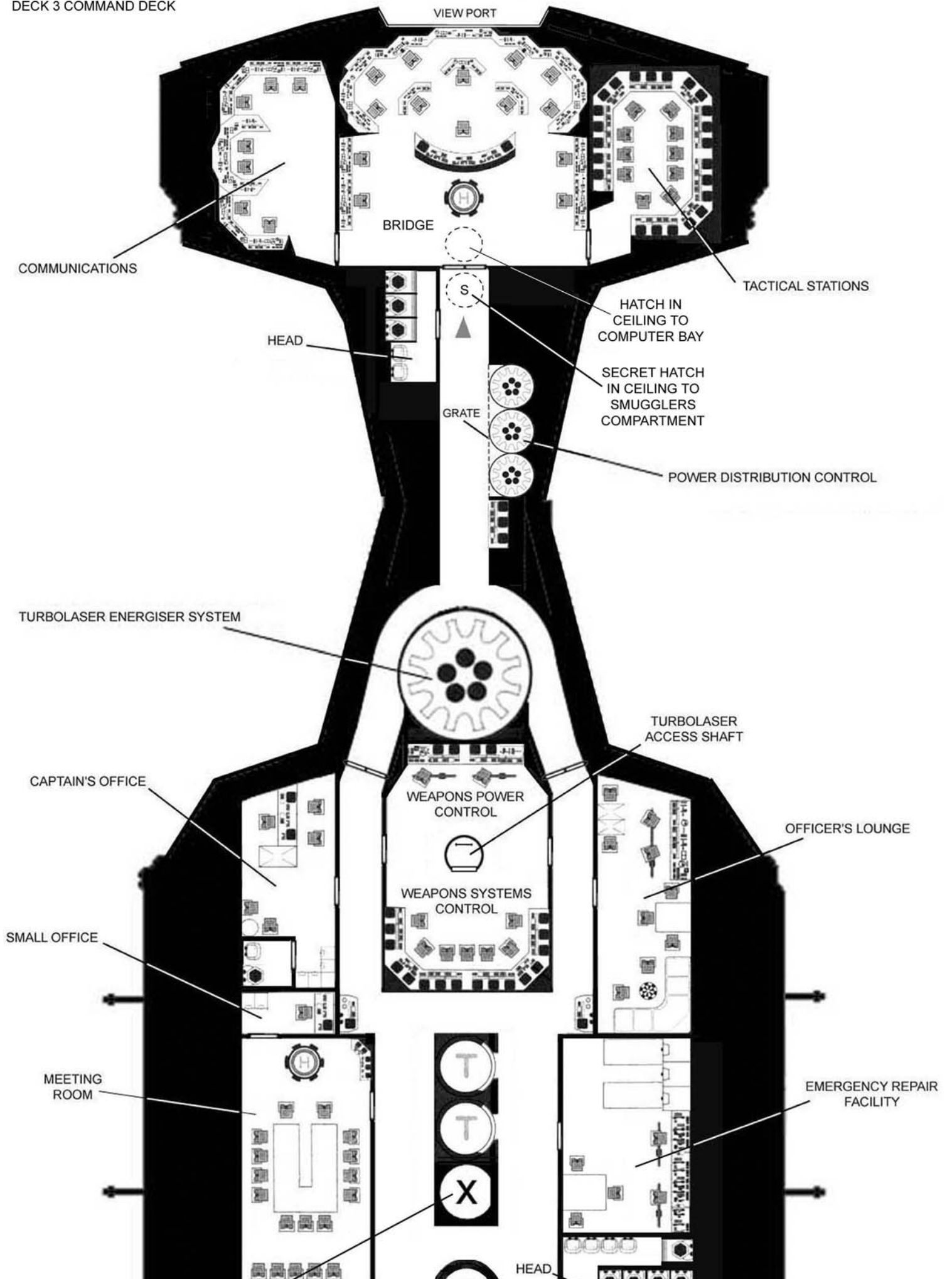

RUNS THROUGH BUT NOT ACCESSIBLE FROM THIS DECK

FREIGHT TURBOLIFT (NOT ACCESSIBLE EXCEPT FROM HOLDS)

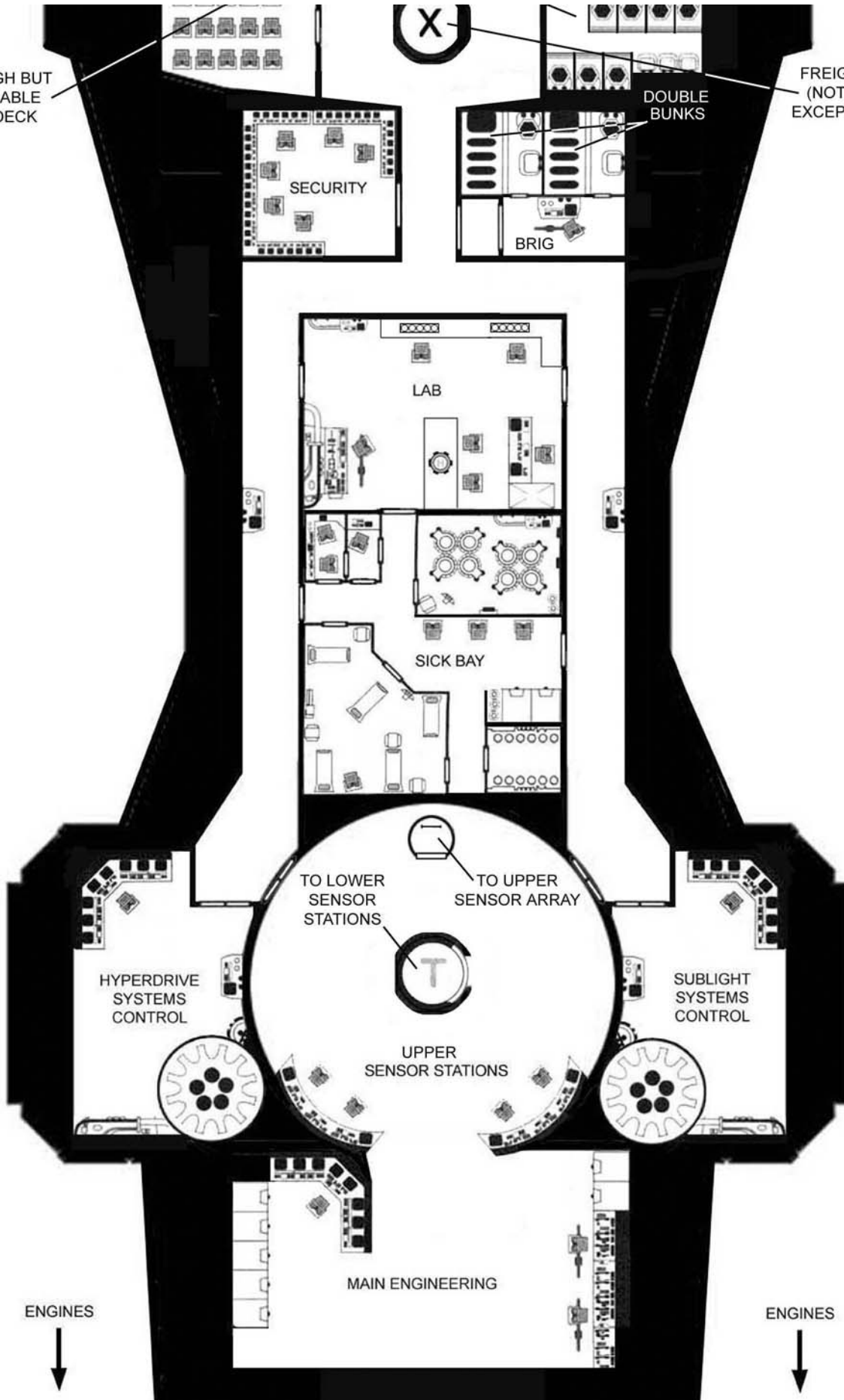

SECURITY

BRIG

DOUBLE BUNKS

LAB

SICK BAY

TO LOWER SENSOR STATIONS

TO UPPER SENSOR ARRAY

HYPERDRIVE SYSTEMS CONTROL

SUBLIGHT SYSTEMS CONTROL

UPPER SENSOR STATIONS

MAIN ENGINEERING

ENGINES

ENGINES

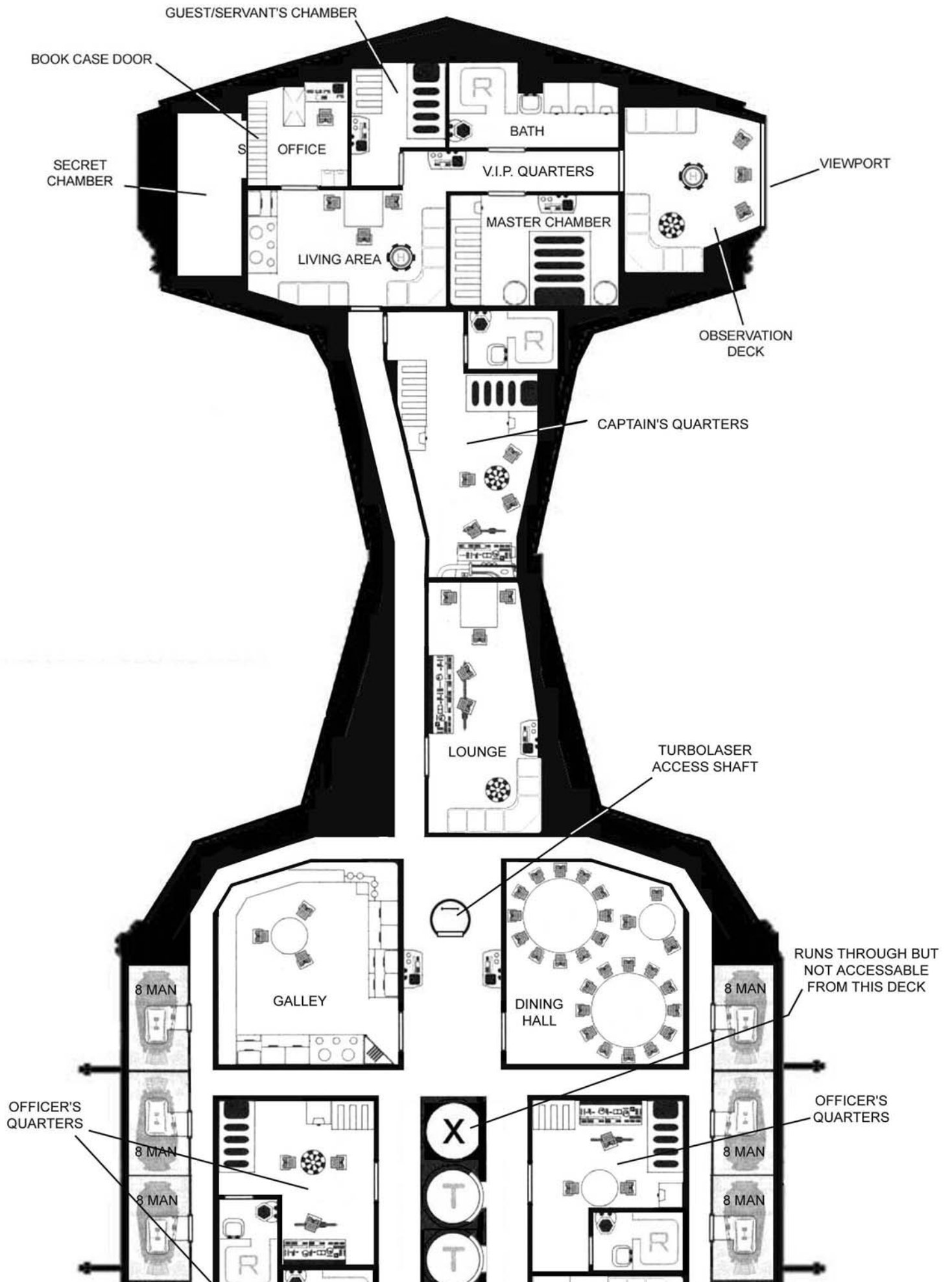

COMMAND
CREW
QUARTERS

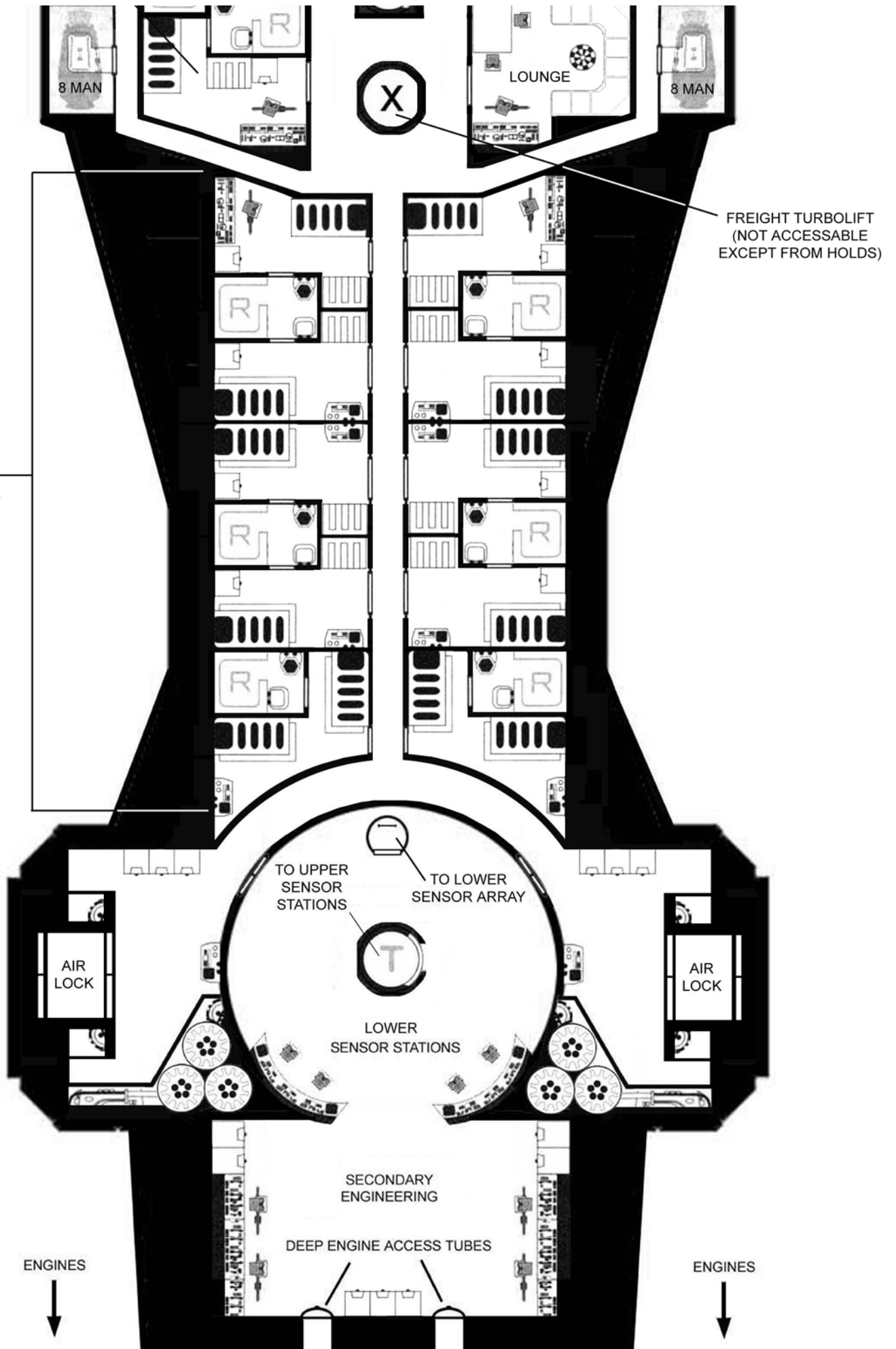

DEEP ENGINE ACCESS
TUBES FOR ENGINE
INSPECTION AND REPAIR





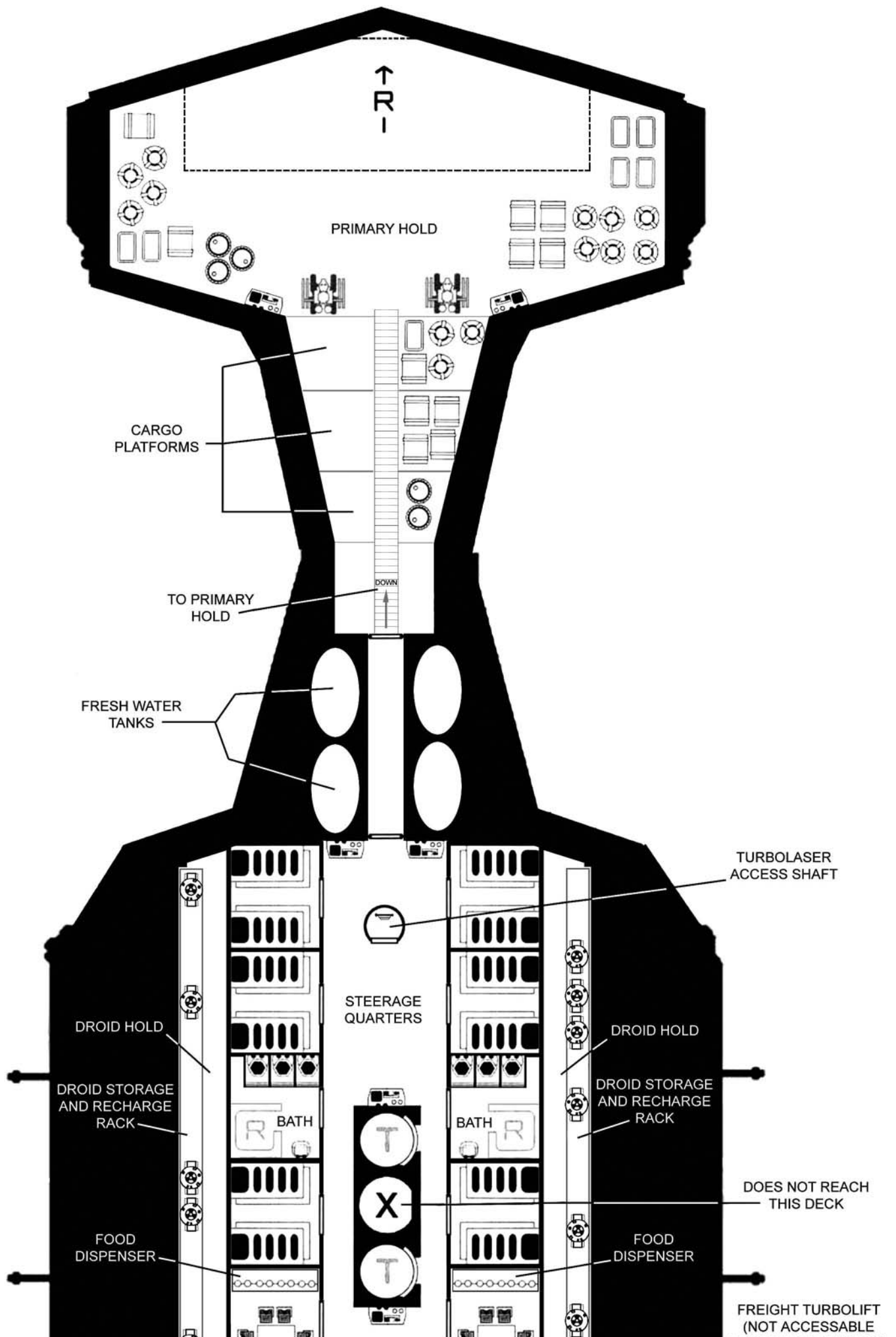

EXCEPT FROM HOLDS)



DECK 1 METER HIGHER



TO BELLY HOLD

TO BELLY HOLD

LOUNGE WITH GALLEY

CHIEF ENGINEER QUARTERS

ENGINEERING CREW QUARTERS

